

Cat. No.	Category	Test Item	Diseases	Specimen Type	Specimen Volume	Reaction Time	Measuring Range	Qualification
W290	<b>COVID-19</b>	2019-nCoV RBD Antibody Test	COVID-19	Fingerstick or Venous WB/ S/P	20µL	15 mins	Quantitative	CE
W295		2019-nCoV RBD IgG Test		Fingerstick or Venous WB/ S/P	20µL	15 mins	Quantitative	CE
W286		2019-nCoV Antigen Test		NP/ OP	/	15 mins	Qualitative	CE
W276		2019-nCoV Antibody Test		S/P/WB	10 µL	10 mins	Qualitative	CE
W278		2019-nCoV IgM/IgG Test			10 µL	10 mins	Qualitative	CE
W241P0002	<b>Vitamin</b>	Vitamin D	Bone Metabolism	S/P	75 µL	15 mins	5~100 ng/mL	CE NMPA
W207	<b>Diabetic &amp; Renal Injury Markers</b>	HbA1c	Diabetes Mellitus	WB	10 µL	5 mins	4.0~14.5%	CE IFCC NGSP NMPA
W206		One Step MAU	Renal Injury	Urine	75 µL	3 mins	5~300 mg/L	CE NMPA
W219		CysC	Renal Injury	S/P/WB	10 µL	5 mins	0.2~10 mg/L	CE NMPA
W228		NGAL	Renal Injury	Urine	75 µL	15 mins	10~1500 ng/mL	CE NMPA
W229		β2-MG	Proximal Renal Tubule Dysfunction	S/P/WB	10 µL	10 mins	0.3~20 mg/L	CE NMPA
W231	<b>Thyroid Function</b>	T3	Thyroid Malfunction	S/P/WB	75 µL	15 mins	0.61~9.22 nmol/L	CE NMPA
W232		T4	Thyroid Malfunction	S/P/WB	75 µL	15 mins	12.87~300 nmol/L	CE NMPA
W220		TSH	Thyroid Malfunction	S/P/WB	75 µL	15 mins	0.1~100 mIU/L	CE NMPA
W200		ft3	Thyroid Malfunction	S/P/WB	75 µL	15 mins	0.40~50.00 pmol/L or 0.26~32.55 pg/mL	CE
W259		ft4	Thyroid Malfunction	S/P/WB	75 µL	15 mins	1.00~100 pmol/L or 0.078~7.77 ng/dL	CE
W225	<b>Fertility</b>	β-HCG	Fertility	S/P/WB	20 µL	15 mins	2~200,000 mIU/mL	CE NMPA
W244		LH	Fertility	S/P/WB	75 µL	15 mins	1~100 mIU/mL	CE NMPA
W245		FSH	Fertility	S/P/WB	75 µL	15 mins	1~100 mIU/mL	CE NMPA
W233		Prog	Fertility	S/P/WB	75 µL	15 mins	1.5~60 ng/mL	CE NMPA
W246P0001		PRL	Fertility	S/P/WB	75 µL	15 mins	1~200 ng/mL	CE NMPA
W247-C4P1-E		E2	Fertility	S/P/WB	75 µL	15 mins	9~3000 pg/mL	CE NMPA
W248-C4P1-E		Testosterone	Fertility	S/P/WB	75 µL	15 mins	0.2~15 ng/mL	CE NMPA
W257P0001		AMH	Fertility	S/P/WB	75 µL	15 mins	0.1~16 ng/mL	CE NMPA
W202	<b>Cardiac Markers</b>	NT-proBNP	Heart Failure	S/P/WB	75 µL	15 mins	18~35000 pg/mL	CE NMPA
W203		cTn I	Myocardial Infarction	S/P/WB	75 µL	15 mins	0.1~50 ng/mL	CE NMPA
W204		Myo	Myocardial Infarction	S/P/WB	75 µL	15 mins	2.0~400 ng/mL	CE NMPA
W205		CK-MB	Myocardial Infarction	S/P/WB	75 µL	15 mins	0.3~100 ng/mL	CE NMPA
W217		H-FABP	Myocardial Infarction	S/P/WB	75 µL	15 mins	1~120 ng/mL	CE NMPA
W216		3 in 1 (cTn I/Myo/CK-MB)	Myocardial Infarction	S/P/WB	75 µL	15 mins	Same with single items	CE NMPA
W222		BNP	Heart Failure	WB/Plasma	75 µL	15 mins	5~5000 pg/mL	CE NMPA
W223		2 in 1 (cTn I/ NT-proBNP)	Myocardial Infarction	S/P/WB	75 µL	15 mins	Same with single items	CE NMPA
W240	hsCRP	CVD	S/P/WB	10 µL	3 mins	0.1~10mg/L	CE NMPA	
W254P0001	One Step cTnT	Myocardial Infarction	S/P/WB	100 µL for whole blood 75 µL for plasma/serum	15 mins	0.03~10 ng/mL	CE NMPA	
W242	Lp-PLA2	Atherosclerosis	S/P/WB	75 µL	15 mins	10~1000 ng/mL	NMPA	
W239	<b>Craniocerebral Injury Markers</b>	S100β	Cerebral Ischemia Cerebral Hemorrhage	S/P/WB	75 µL	15 mins	0.05~10 ng/mL	NMPA
W211	<b>Coagulation</b>	D-Dimer	Thrombosis	WB/Plasma	15 µL for whole blood 10 µL for plasma	5 mins	0.1~10 mg/L	CE NMPA
W227		One step D-Dimer	Thrombosis	WB/Plasma	100 µL for whole blood 75 µL for plasma/serum	15 mins	0.1~10 mg/L	CE NMPA
W210/ W210P0004	<b>Inflammation Markers</b>	PCT	Sepsis	S/P/WB	75 µL for whole blood 50 µL for plasma/serum	15 mins	0.1~100 ng/mL	CE NMPA
W201		CRP (hsCRP+CRP)	Infection	S/P/WB	8.5 µL for whole blood 5 µL for plasma/serum	3 mins	0.5~200 mg/L	CE NMPA
W218		2 in 1 (CRP+PCT)	Infection	S/P/WB	75 µL	15 mins	CRP:0.5~150 mg/L PCT:0.1~100 ng/mL	CE NMPA
W221		SAA	Infection	S/P/WB	10 µL	15 mins	1.0~300 mg/L	CE NMPA
W251P0001		IL-6	Infection	S/P/WB	75 µL	15 mins	3~4000 pg/mL	CE NMPA
W208	<b>Tumor Markers</b>	AFP	Liver Cancer	S/P/WB	75 µL	15 mins	5~400 ng/mL	CE NMPA
W209		PSA	Prostate Cancer	S/P/WB	75 µL	15 mins	2~100 ng/mL	CE <sub>0123</sub> NMPA
W226		CEA	Cancer	S/P/WB	75 µL	15 mins	1~500 ng/mL	CE NMPA
W230		fPSA	Prostate Cancer	S/P/WB	75 µL	15 mins	0.2~30 ng/mL	CE <sub>0123</sub> NMPA
W282P0001	<b>Infection</b>	Dengue NS1 Ag	Infectious disease	WB/Serum/Plasma	75 µL	12 mins	Qualitative	CE
W297P0001		ASO	Rheumatic fever and glomerulonephritis	WB/Serum/Plasma	10 µL	5 mins	20~1000 IU/mL	CE
W298P0001	<b>Autoimmune</b>	Total IgE	Allergic diseases	WB/Serum/Plasma	75 µL	10 mins	1~1000 IU/mL	CE
W250	<b>Others</b>	Cortisol	Cortisol disorders	S/P/WB	75 µL	15 mins	50~1000 nmol/L	CE NMPA
W269P0001		Ferritin	Iron metabolism	S/P/WB	75 µL	10 mins	5~1000 ng/mL	CE
W279P0001		iFOB	Gastrointestinal bleeding	Feces	stick to sample at 6 different parts of the feces	5 mins	25~1000 ng/mL	CE

\* Ongoing: Dengue IgM/IgG, RF, H. Pylori Antigen, Anti-CCP, Influenza A & B.

Guangzhou Wondfo Biotech Co., Ltd.

No. 8 Lizhishan Road, Science City, Luogang District, 510663 Guangzhou, P.R.China

Tel: (+86) 400-830-8768 Website: en.wondfo.com.cn E-mail: sales@wondfo.com.cn

Wondfo reserves all rights. All contents of this brochure are copyrighted by Wondfo.



Rev. A2 Rel.: 2022/04/28



Racing For Life

**Finecare™**

**FIA Meter II Plus SE (FS-114)**

REF **W911**

Fluorescence Immunoassay Analyzer

CE NGSP ifcc

# Fluorescence Immunoassay Analyzer

## FS-114

- Dimension : 239 x 278 x 148mm
- Weight : 3.3kg

## Built-in Thermal Printer

- Real-time auto-printing
- Support for external printer

## Connectivity

- Wifi connection to LIS/HIS
- RS 232 and Ethernet port
- 4 USB ports

## ID Chip Port

- Automatically reading of batch number and calibration information in the ID chip

## Designed Sampler

- Specially-designed sampler for small volume of specimen



## Linux System

- Smooth operation
- Security system
- Custom intelligent management module
- Multi-user management

## Large Display

- 8" LCD Capacitive touch screen
- Intuitive user interface

## Portability

- 7800mAh battery
- Internal rechargeable battery
- 21-hours stand by time
- ≥200 tests without power supply

## Test Device Tray 40+ Test Items

- Multiple testing modes available
- Unique quick mode for largenumber of samples

## Test Reagent

- Suitable for whole blood,serum, plasma and urine
- Room temperature storage
- Get results in 3-15 minutes

# Technical Advantages



## Portable

- Small size,
- 7800mAh built-in battery



## Convenient

- Easy to operate,
- large curved handle



## Instant Results

- Get results in 3-15 minutes



## Reliable Accuracy

- Good correlation with CLIA method



## Temperature Control

- Provide better reaction condition

# Operation Procedure

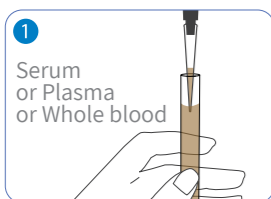

Sampling

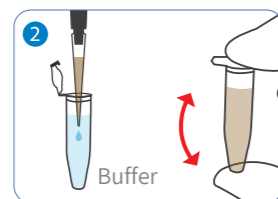

Mixing

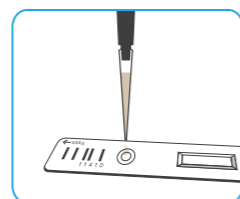

Dropping

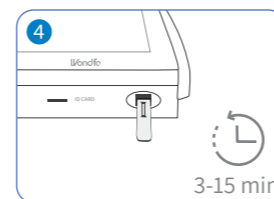

Reading

# Application



Laboratory



ER



Ambulance



Clinics



ICU



Clinical department